



Dental Clinic  
Iveco Eurocargo 150E22H / WB: 5175  
Size: L.6800 / W.2400 / H.2500

Project No	Revision No	Date	Page
18.234	000	27.10.2018	1 / 11

ALURA TRAILER  
P +90 332 3460080 F + 90 332 3460090 M +90 544 242 04 91  
Yazır Mah. Sultan Cad. 34/407 Selçuklu / Konya / TURKEY  
[www.aluratrailer.com](http://www.aluratrailer.com) [sales@aluratrailer.com](mailto:sales@aluratrailer.com)



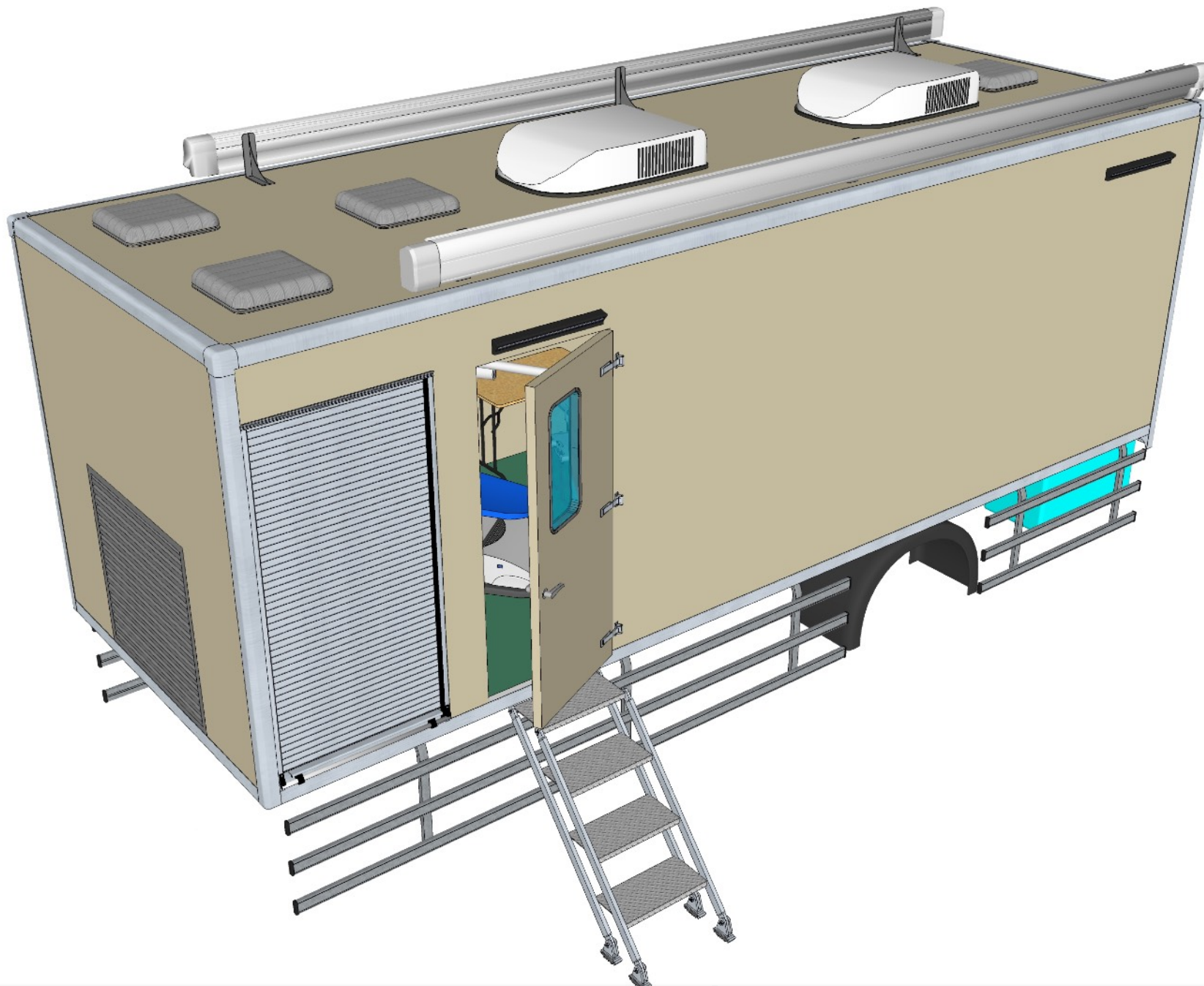

**Dental Clinic**  
**Iveco Eurocargo 150E22H / WB: 5175**

Prct. No : 18.234  
Rev. : 000  
Date : 27.10.2018  
Page : 2 / 11

ALURA TRAILER  
P: +90 332 3460080  
M :+90 544 242 04 91  
[www.aluratrailer.com](http://www.aluratrailer.com)

[sales@aluratrailer.com](mailto:sales@aluratrailer.com)



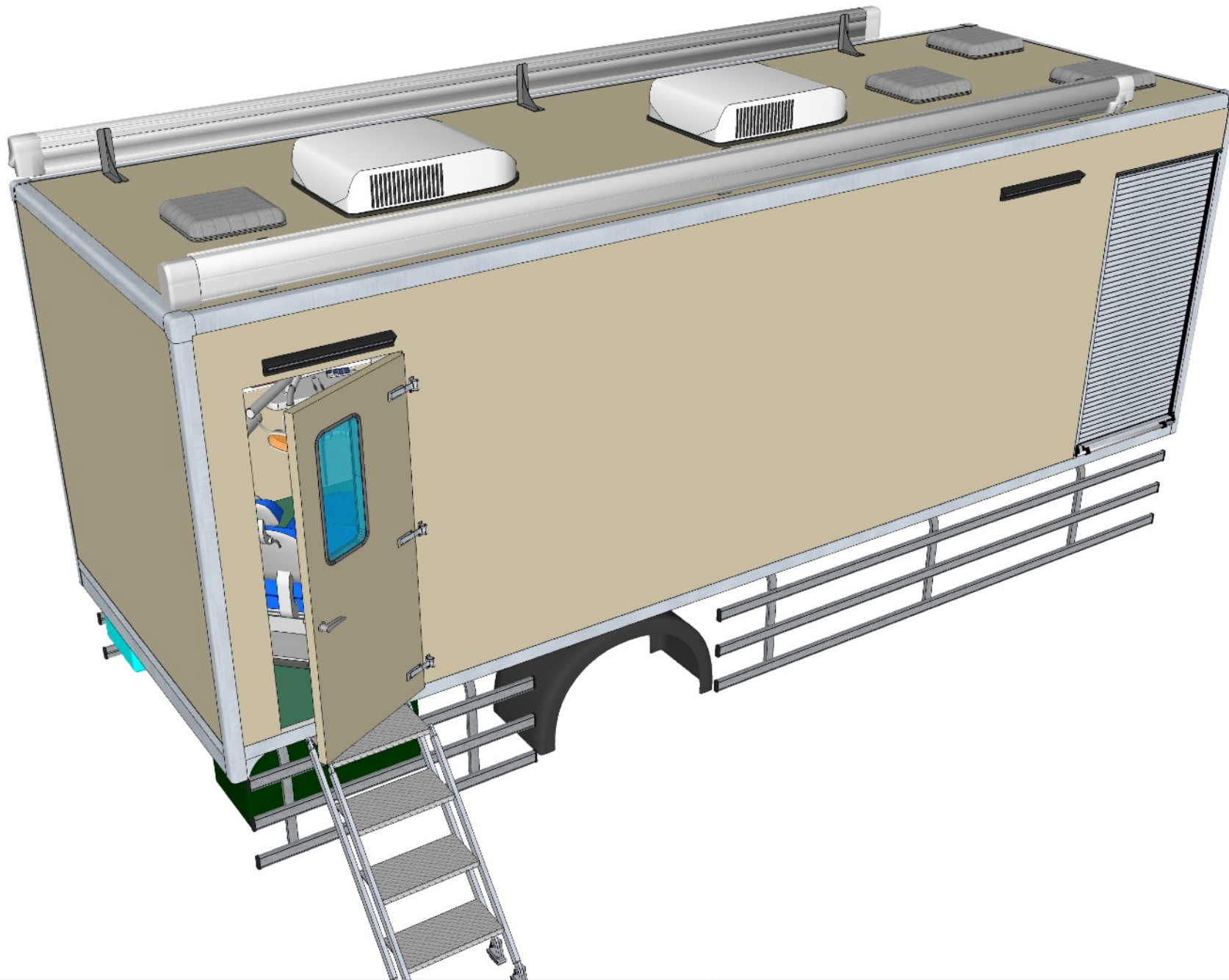

**Dental Clinic**  
**Iveco Eurocargo 150E22H / WB: 5175**

Prct. No : 18.234  
Rev. : 000  
Date : 27.10.2018  
Page : 3 / 11

ALURA TRAILER  
P: +90 332 3460080  
M :+90 544 242 04 91  
[www.aluratrailer.com](http://www.aluratrailer.com)

[sales@aluratrailer.com](mailto:sales@aluratrailer.com)



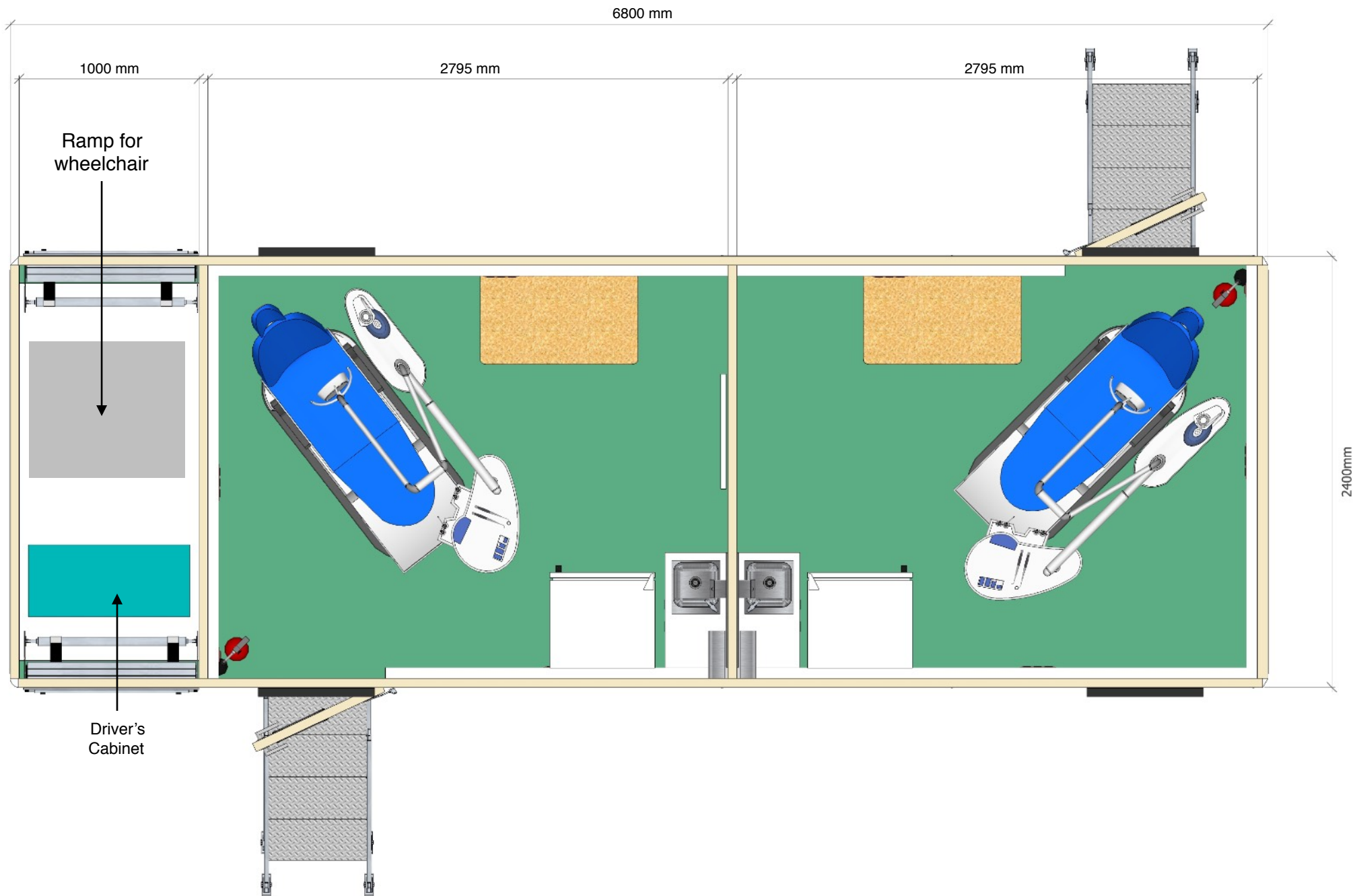

**Dental Clinic**  
**Iveco Eurocargo 150E22H / WB: 5175**

Prct. No : 18.234  
 Rev. : 000  
 Date : 27.10.2018  
 Page : 4 / 11

ALURA TRAILER  
 P: +90 332 3460080  
 M :+90 544 242 04 91  
[www.aluratrailer.com](http://www.aluratrailer.com)

[sales@aluratrailer.com](mailto:sales@aluratrailer.com)



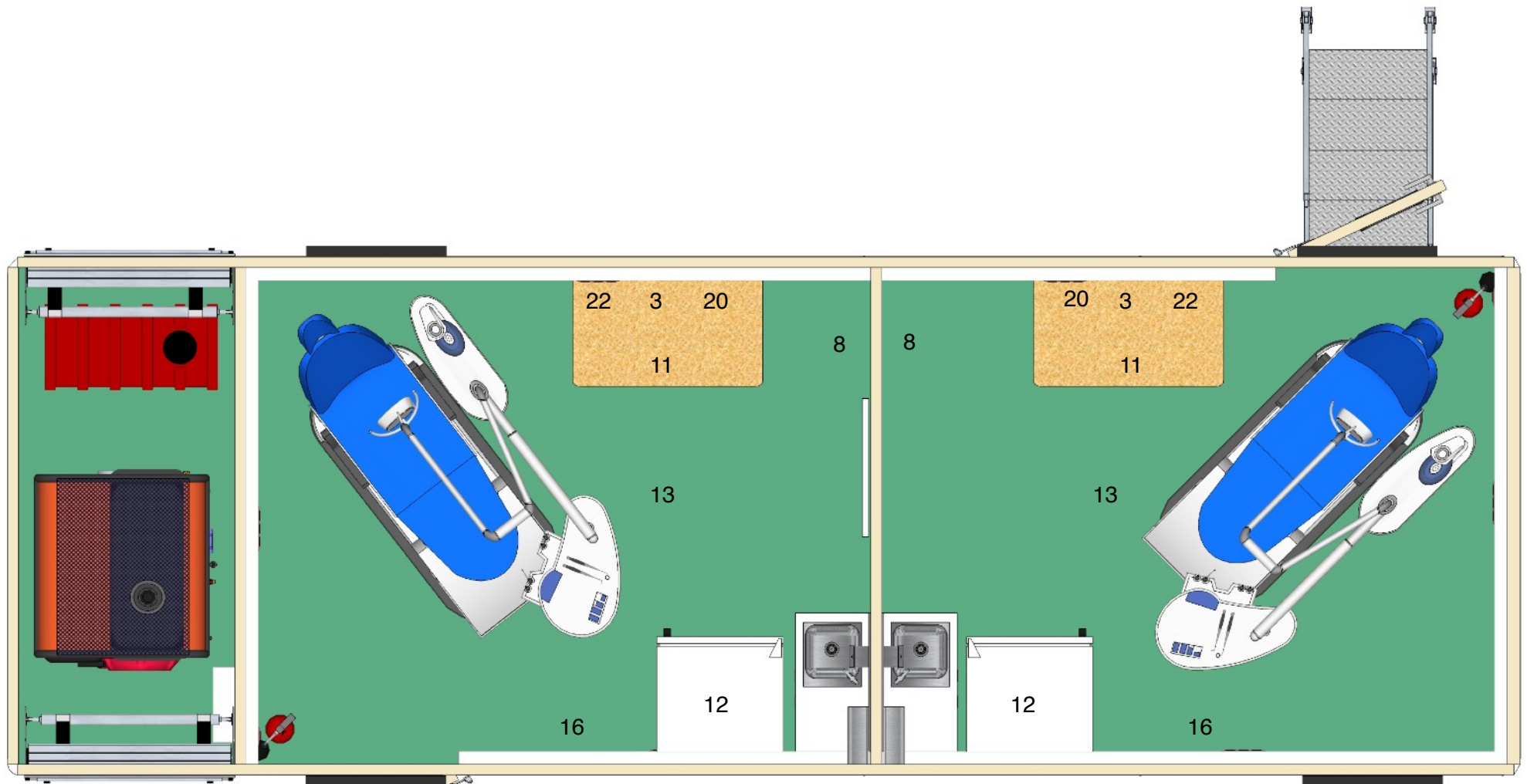

- 20. Amalgamators
- Drawing. Dental Delivery Unit
- 22. Lights, Dental Activator ( light cure device )
- 3. Sterilizing Units, Steam, Tabletop
- 8. Dispensers, Disinfectant
- 9. Dispensers, Soap
- 11. Foldable Table
- 12. Refrigerator
- 13. Stools, Adjustable
- 14. Waste Receptacles



**Dental Clinic**  
**Iveco Eurocargo 150E22H / WB: 5175**

Prct. No : 18.234  
 Rev. : 000  
 Date : 27.10.2018  
 Page : 5 / 11

ALURA TRAILER  
 P: +90 332 3460080  
 M :+90 544 242 04 91  
[www.aluratrailer.com](http://www.aluratrailer.com)

[sales@aluratrailer.com](mailto:sales@aluratrailer.com)



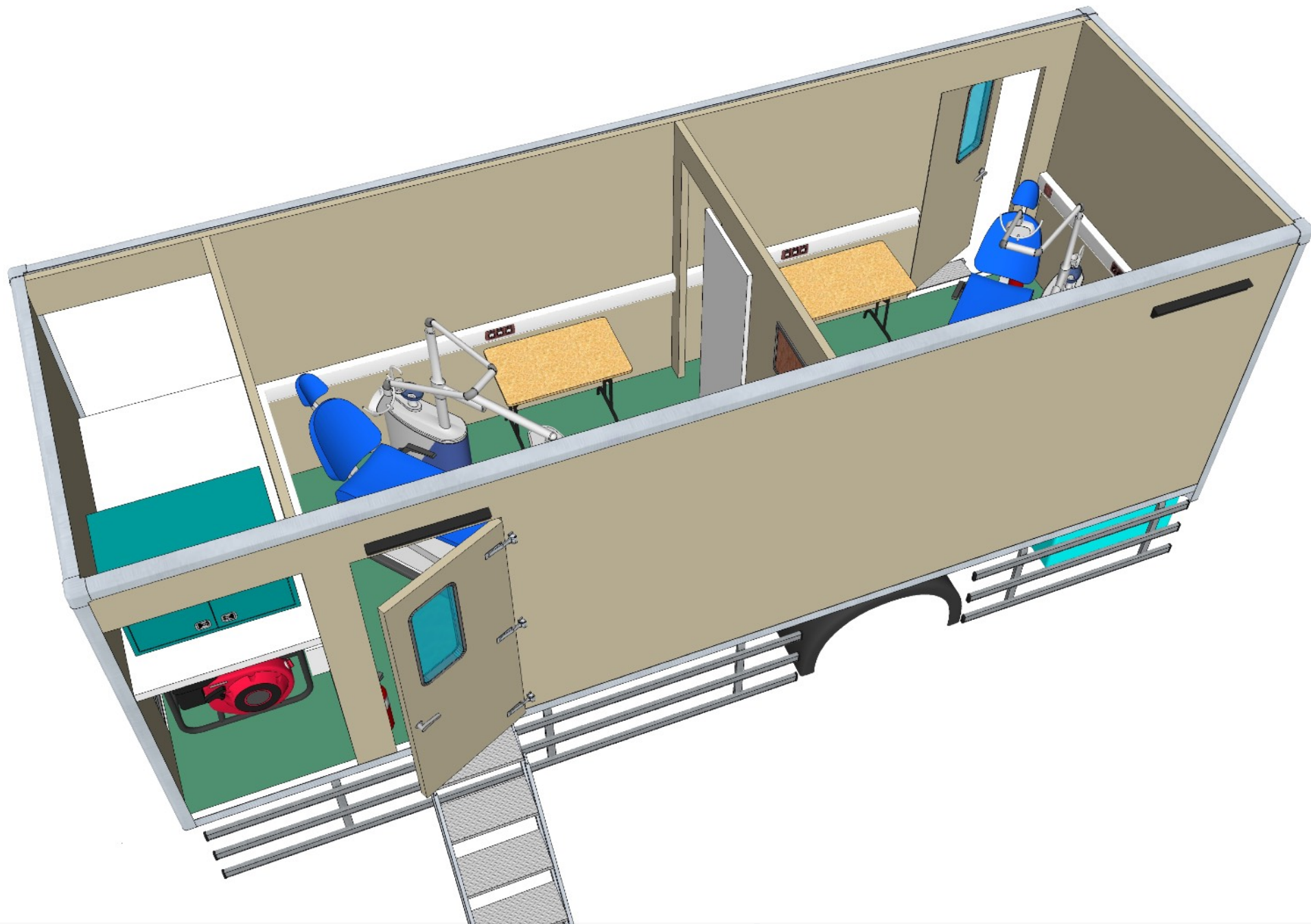

**Dental Clinic**  
**Iveco Eurocargo 150E22H / WB: 5175**

Prct. No : 18.234  
Rev. : 000  
Date : 27.10.2018  
Page : 6 / 11

ALURA TRAILER  
P: +90 332 3460080  
M :+90 544 242 04 91  
[www.aluratrailer.com](http://www.aluratrailer.com)

[sales@aluratrailer.com](mailto:sales@aluratrailer.com)



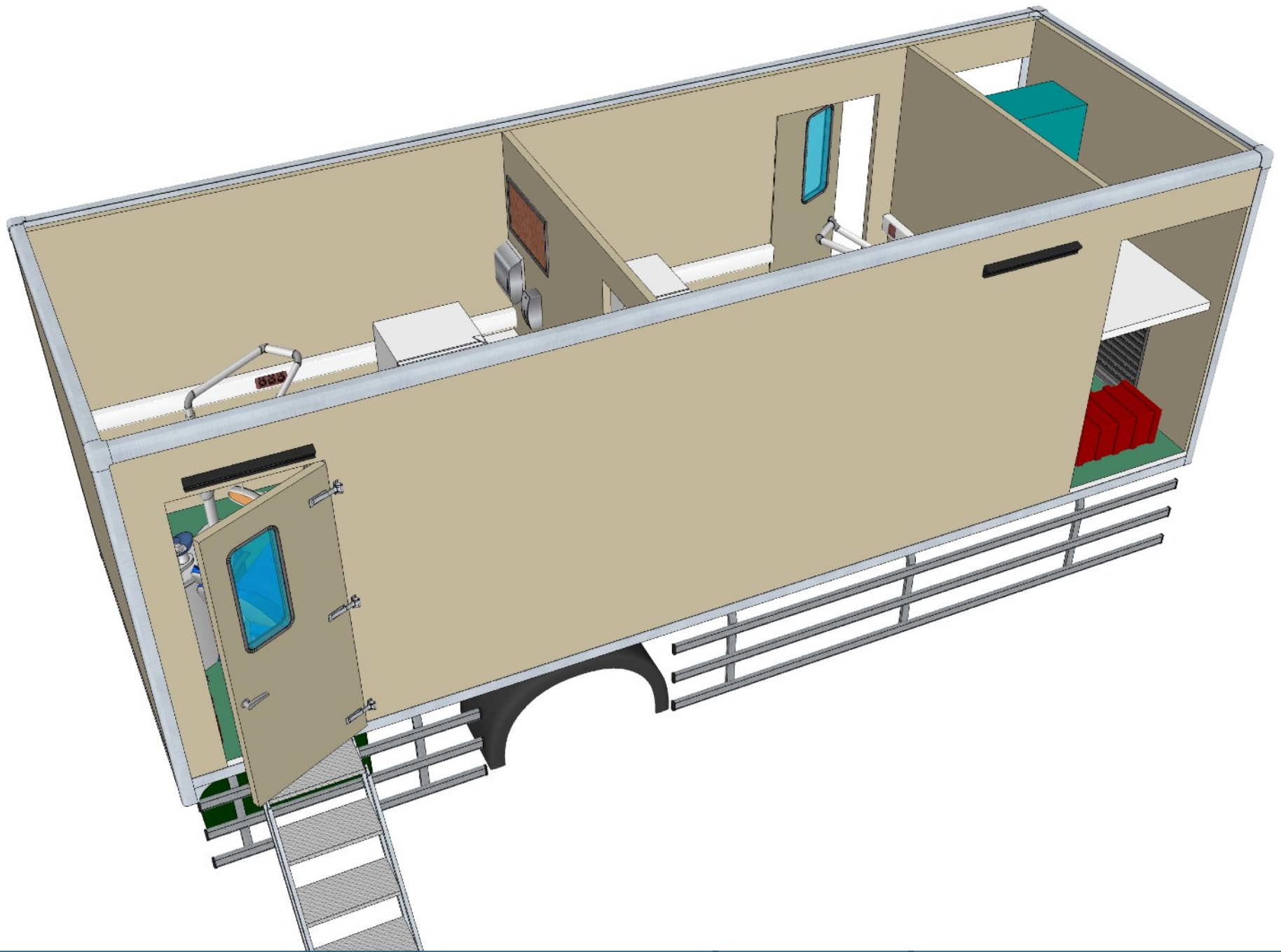

**Dental Clinic**  
**Iveco Eurocargo 150E22H / WB: 5175**

Prct. No : 18.234  
Rev. : 000  
Date : 27.10.2018  
Page : 7 / 11

ALURA TRAILER  
P: +90 332 3460080  
M :+90 544 242 04 91  
[www.aluratrailer.com](http://www.aluratrailer.com)

[sales@aluratrailer.com](mailto:sales@aluratrailer.com)



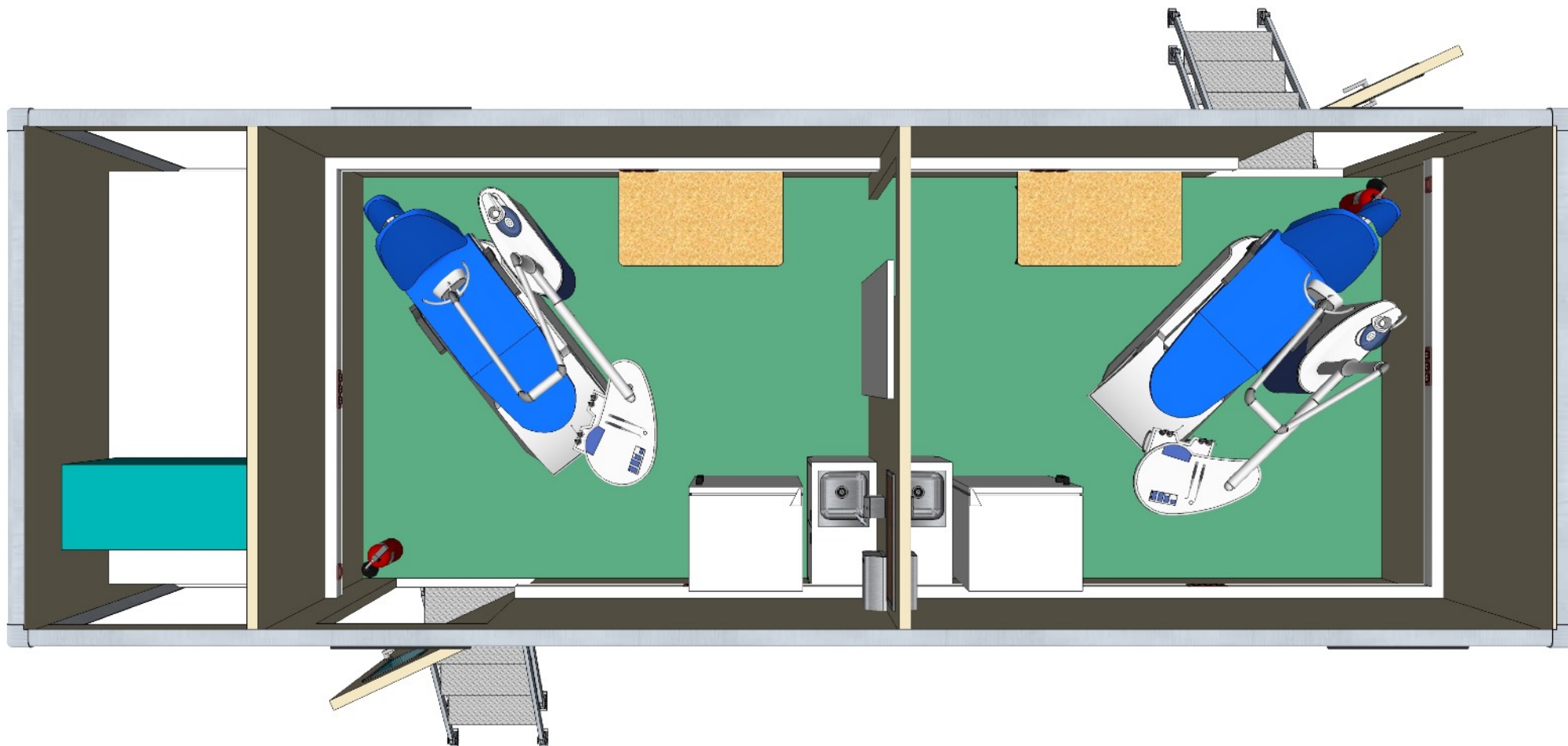

Dental Clinic  
Iveco Eurocargo 150E22H / WB: 5175

Prct. No : 18.234  
Rev. : 000  
Date : 27.10.2018  
Page : 8 / 11

ALURA TRAILER  
P: +90 332 3460080  
M :+90 544 242 04 91  
[www.aluratrailer.com](http://www.aluratrailer.com)

[sales@aluratrailer.com](mailto:sales@aluratrailer.com)





# Equipment list

<p><i>Generator</i></p>		<p>12 kVa Stand By 11 kVa Prime 220 V Working Voltage Honda Engine GX 630 Automatic Start Air Cooling</p>	<p>1 pcs</p>	<p>HONDA</p>	<p>Japan</p>
<p><i>Generator</i></p>		<p>Plastik Fuel Tank 70 lt 80 X 28 X 40 Cm</p>	<p>1 pcs</p>	<p>CAN SB</p>	<p>Italian</p>
<p><i>Air Conditioning</i></p>		<p>3200 / 10900. Cooling capacity (watts/Btu/h) 1600 Heating capacity (watts) 230 volts AC/50 Hz Input voltage 5.9/6.5 – Current consumption R410a Refrigerant</p>	<p>2 pcs</p>	<p>DOMETIC</p>	<p>Germany</p>
<p><i>Awning</i></p>		<p>Articulated awning 6 mt X 3 mt</p>	<p>2 pcs</p>	<p>TENTEKS</p>	<p>Turkey</p>
<p><i>Water Transfer</i></p>		<p>0,55 Hp Engine Power 0,4 Kw Power 1 m3/H Flow rate 220 V 50 Hz Voltage 1”/1” Suction / Delivery</p>	<p>1 pcs</p>	<p>KRESS</p>	<p>Italian</p>
<p><i>Water Transfer</i></p>		<p>Krom Clean Water Tank 2 mm / 300 lt.</p>	<p>1 pcs</p>	<p>ALURA</p>	<p>Turkey</p>
<p><i>Water Transfer</i></p>		<p>Krom Prisma Dirty Water Tank 2 mm / 300 lt.</p>	<p>1 pcs</p>	<p>ALURA</p>	<p>Turkey</p>

Bathroom		Filling Capacity: 8 Liter Sink Material: Stainless Steel	1 pcs	CANKROM	Turkey
Bathroom		Hot / cold, chrome. Height 15 cm. Hose length 150 cm.	1 pcs	CANKROM	Turkey
Bathroom		Electric Water Heater 230 V ~, 50 Hz Power supply 3.7 A Power con. (at 230 V) 14 litres Water capacity 70 °C Temperature limit 2.8 bar Pump pressuremax. 4.5 bar System pressuremax. 3 kg Weight, emptyapprox. 405 x 405 x 295 mm Dimensions	1 pcs	TRUMA	Germany
Shutters		Aluminum Shutters Manuel Working Locking Systems Size : 2100 x 1000 mm	2	HAKSAN	Turkey
Outdoor Lighting		5800 Lumens 240 Watts 30 Cm long 30,000 hours working life IP67 Standard	4 pcs	ALURA	Turkey
Central Control Panel		Control panel of all equipments	1 pcs	ALURA	Turkey
Fire Extinguisher		6 kg fire extinguisher refillable	2 pcs	ALURA	Turkey



ALURA TRAILER

P +90 332 3460080 F + 90 332 3460090 M +90 544 2420491  
Yazır Mah. Sultan Cad. 34/407 Selçuklu / Konya / TURKEY  
[www.aluratrailer.com](http://www.aluratrailer.com) [sales@aluratrailer.com](mailto:sales@aluratrailer.com)

