

Cafeteria



Cafeteria

Iveco Eurocargo 150E22H / WB: 5175

Size: L.6800 / W.2400 / H.2500

Project No	Revision No	Date	Page
18.245	000	27.10.2018	1 / 12

ALURA TRAILER

P +90 332 3460080 F + 90 332 3460090 M +90 544 242 04 91

Yazır Mah. Sultan Cad. 34/407 Selçuklu / Konya / TURKEY

www.aluratrailer.com sales@aluratrailer.com



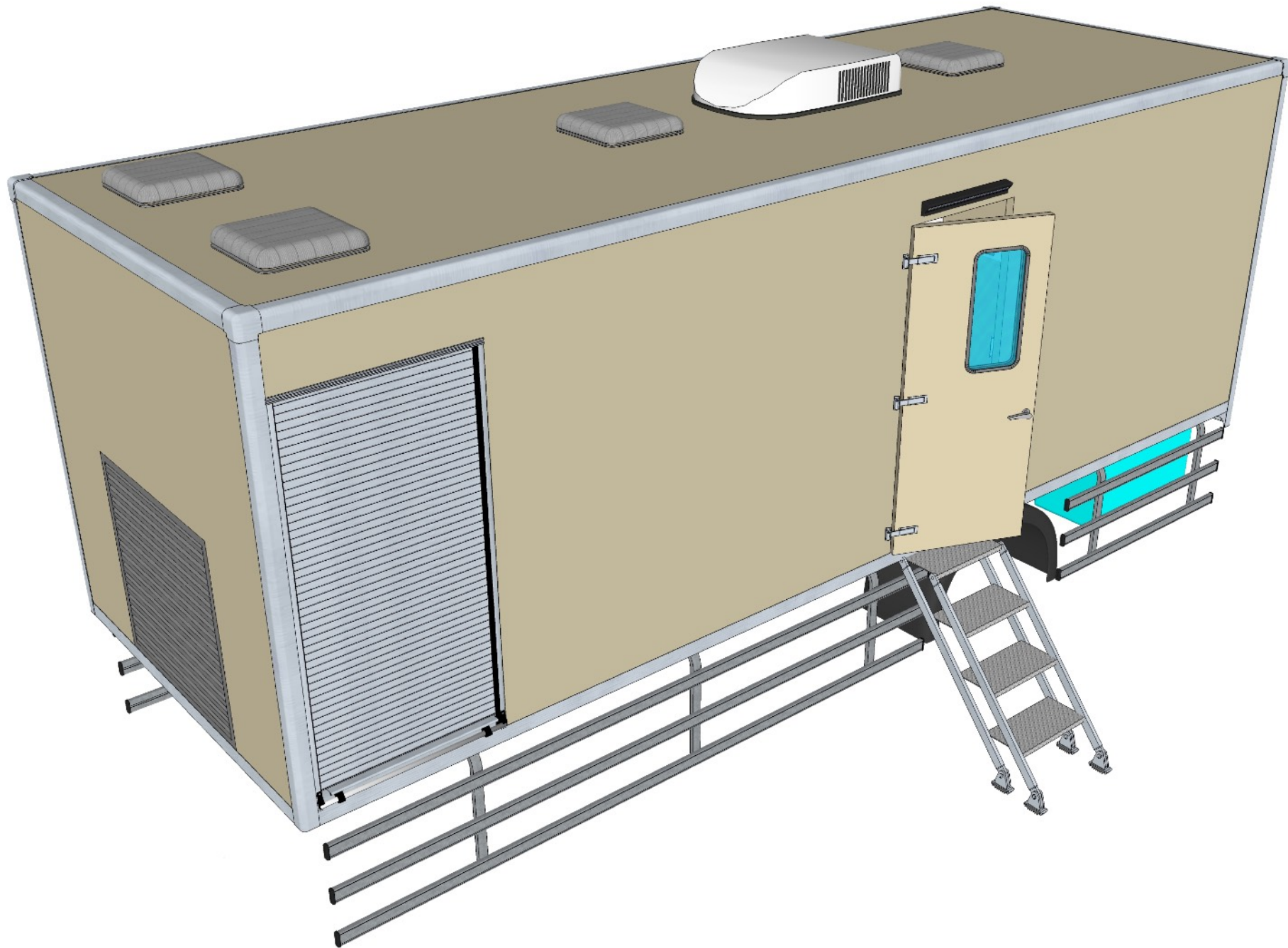

Cafeteria
Iveco Eurocargo 150E22H / WB: 5175

Prct. No : 18.245
Rev. : 000
Date : 27.10.2018
Page : 2 / 12

ALURA TRAILER
P: +90 332 3460080
M :+90 544 242 04 91
www.aluratrailer.com

sales@aluratrailer.com



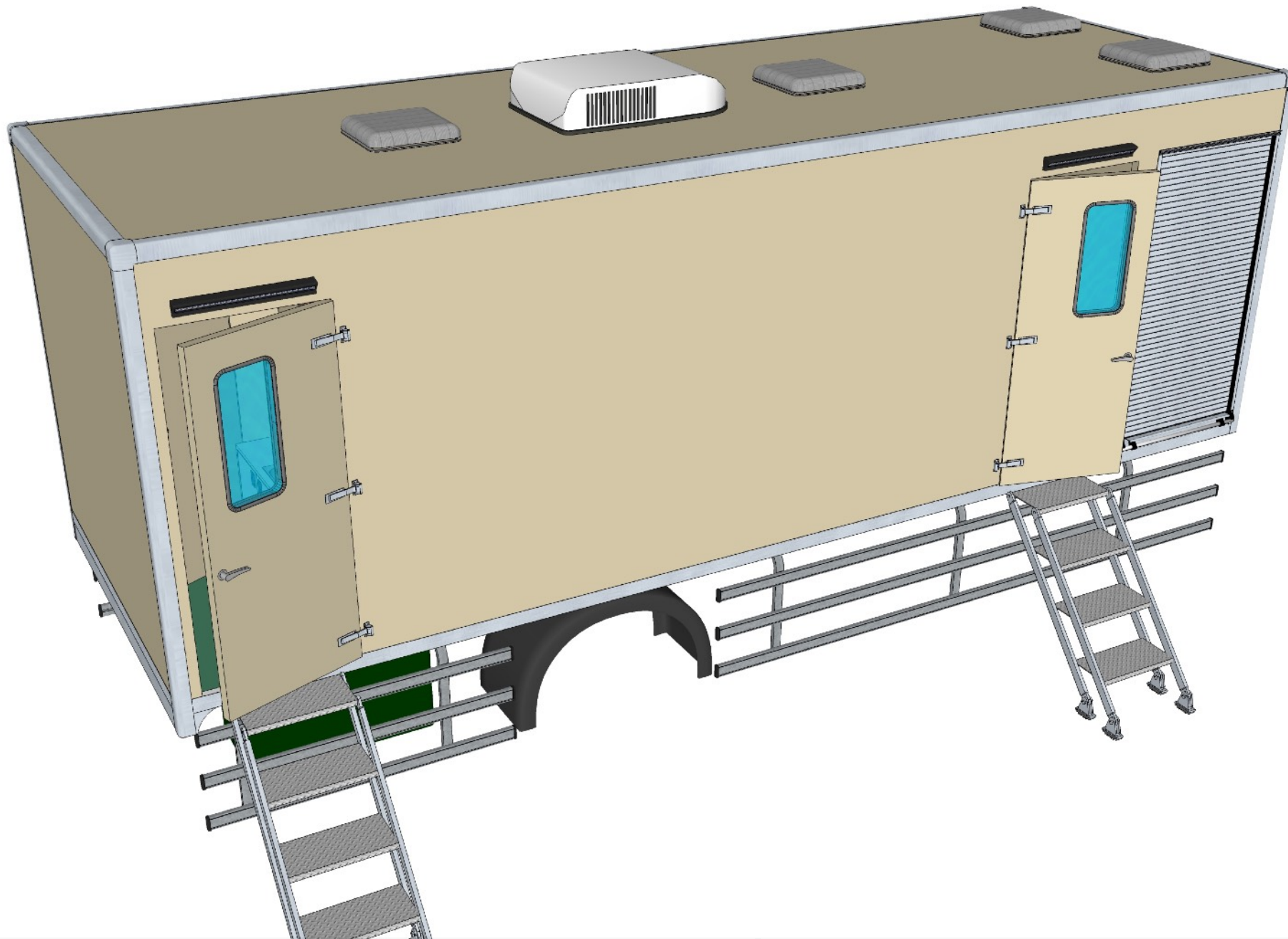

Cafeteria
Iveco Eurocargo 150E22H / WB: 5175

Prct. No : 18.245
Rev. : 000
Date : 27.10.2018
Page : 3 / 12

ALURA TRAILER
P: +90 332 3460080
M :+90 544 242 04 91
www.aluratrailer.com

sales@aluratrailer.com



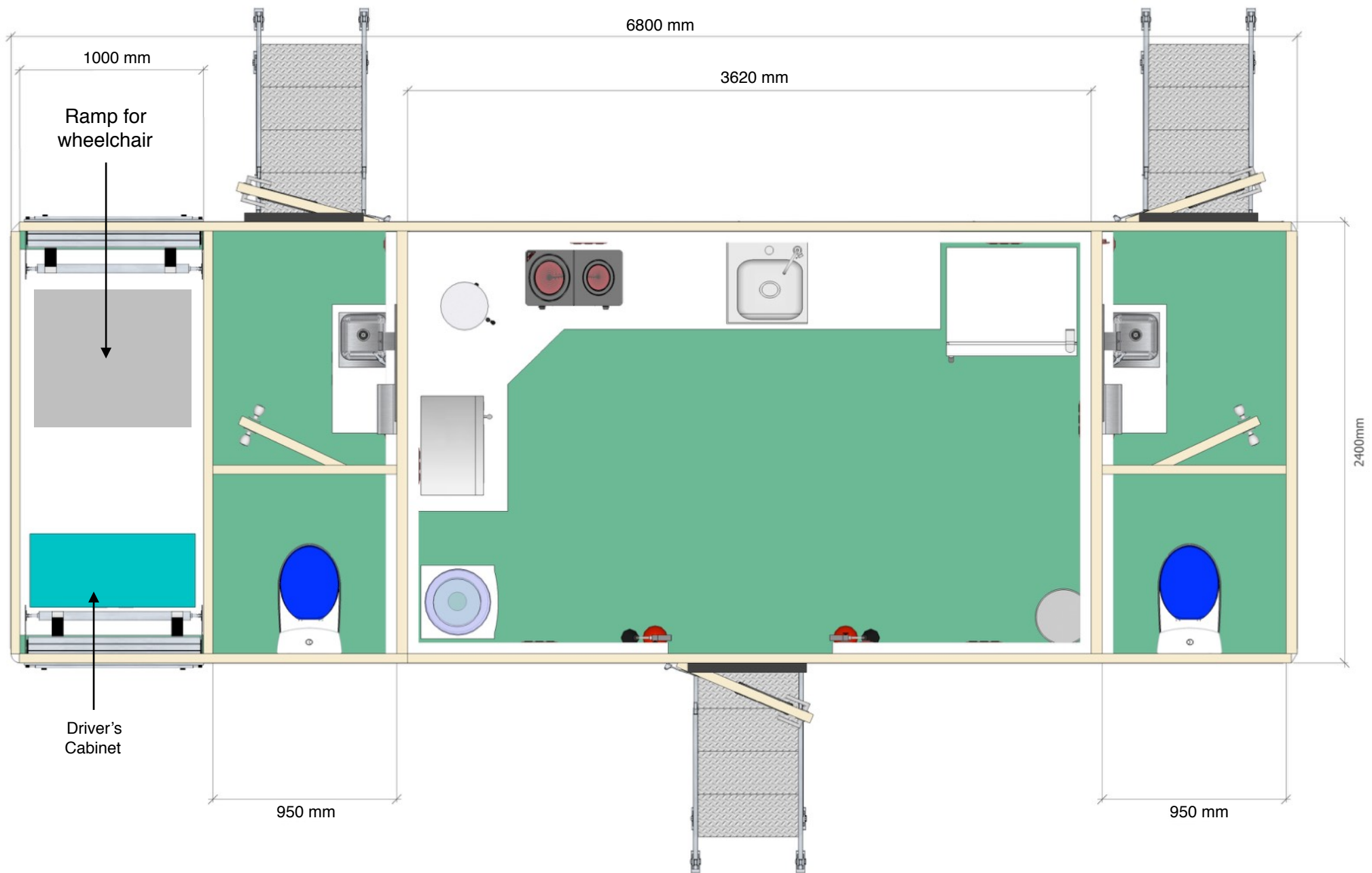

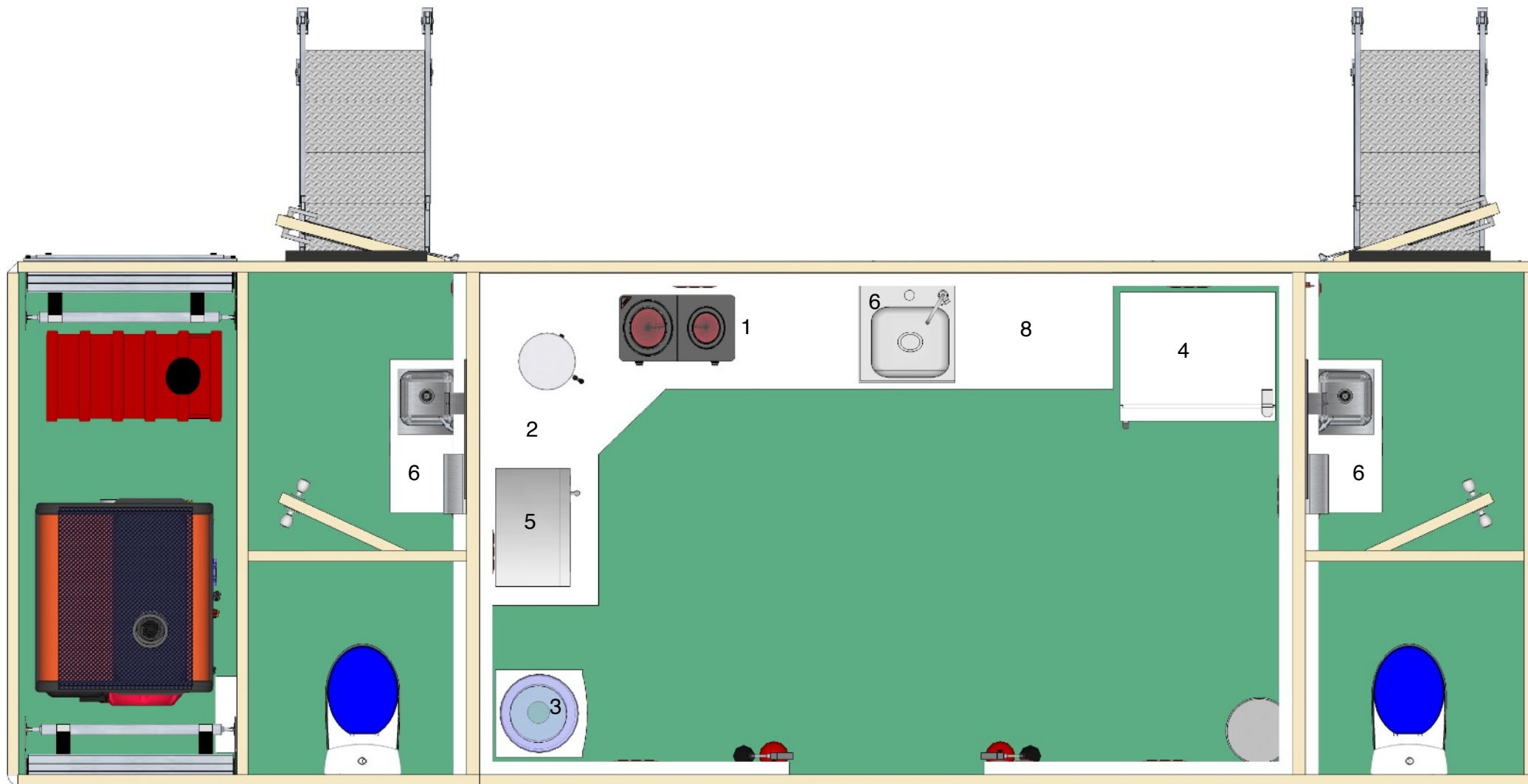

1. Electric stove
2. Electric boiler
3. Water dispenser
4. Refrigerator
5. Microwave
6. Water sink unit
7. Fresh water tank
8. Drawing. Corner kitchen ware unit



Cafeteria
Iveco Eurocargo 150E22H / WB: 5175

Prct. No : 18.245
 Rev. : 000
 Date : 27.10.2018
 Page : 5 / 12

ALURA TRAILER
 P: +90 332 3460080
 M :+90 544 242 04 91
www.aluratrailer.com

sales@aluratrailer.com



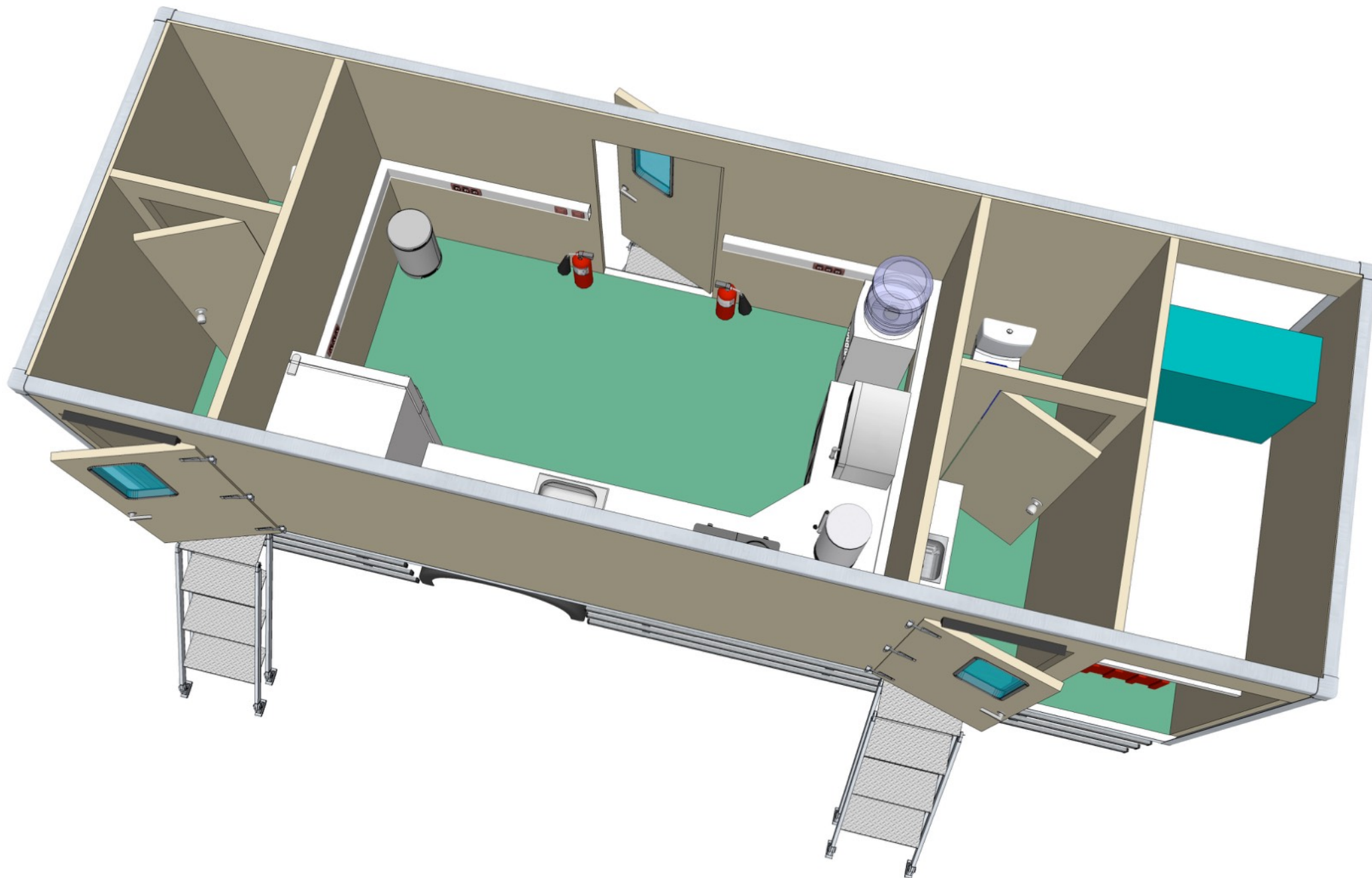

Cafeteria
Iveco Eurocargo 150E22H / WB: 5175

Prct. No : 18.245
Rev. : 000
Date : 27.10.2018
Page : 6 / 12

ALURA TRAILER
P: +90 332 3460080
M :+90 544 242 04 91
www.aluratrailer.com

sales@aluratrailer.com



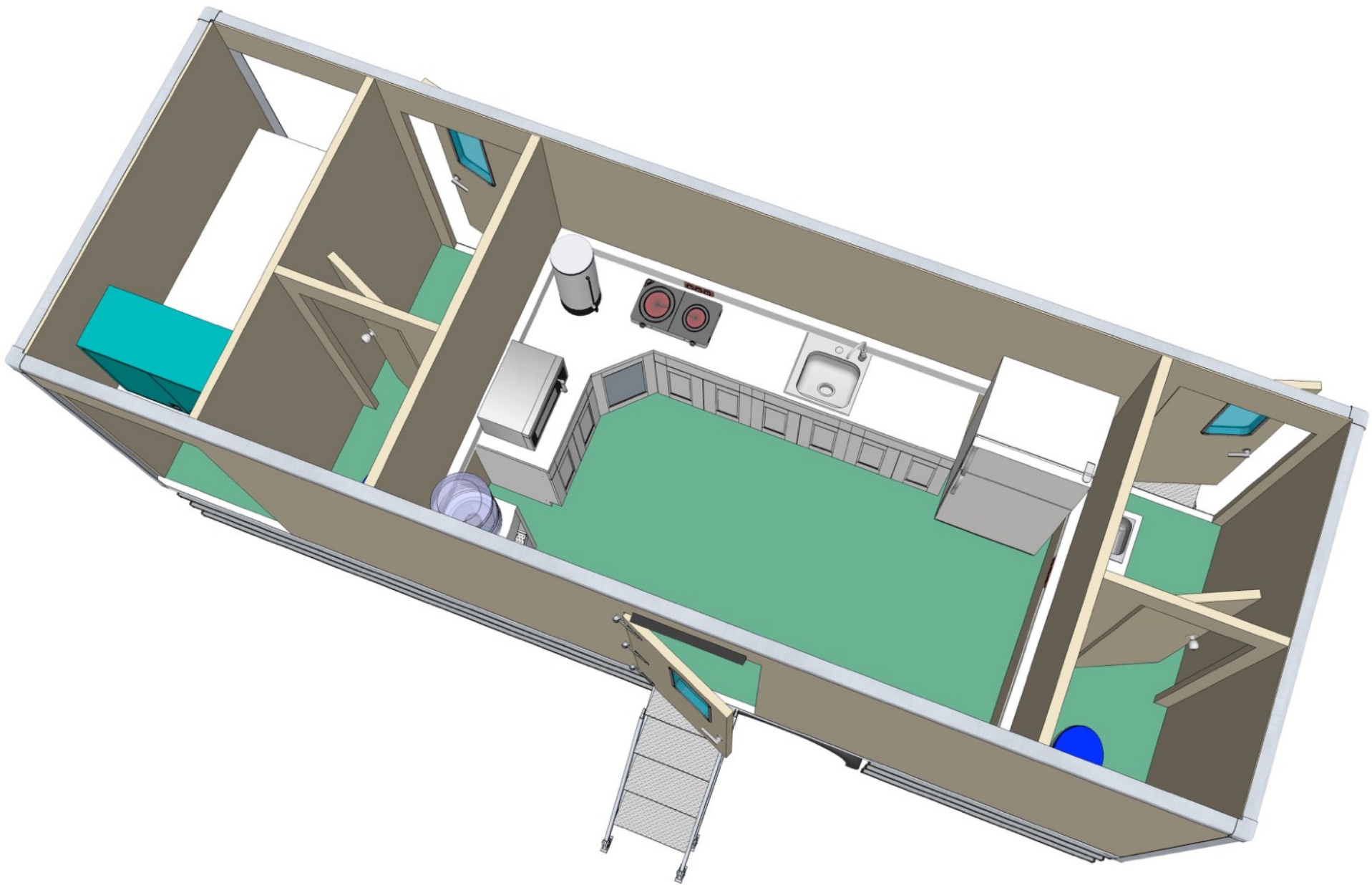

Cafeteria
Iveco Eurocargo 150E22H / WB: 5175

Prct. No : 18.245
Rev. : 000
Date : 27.10.2018
Page : 7 / 12

ALURA TRAILER
P: +90 332 3460080
M :+90 544 242 04 91
www.aluratrailer.com

sales@aluratrailer.com



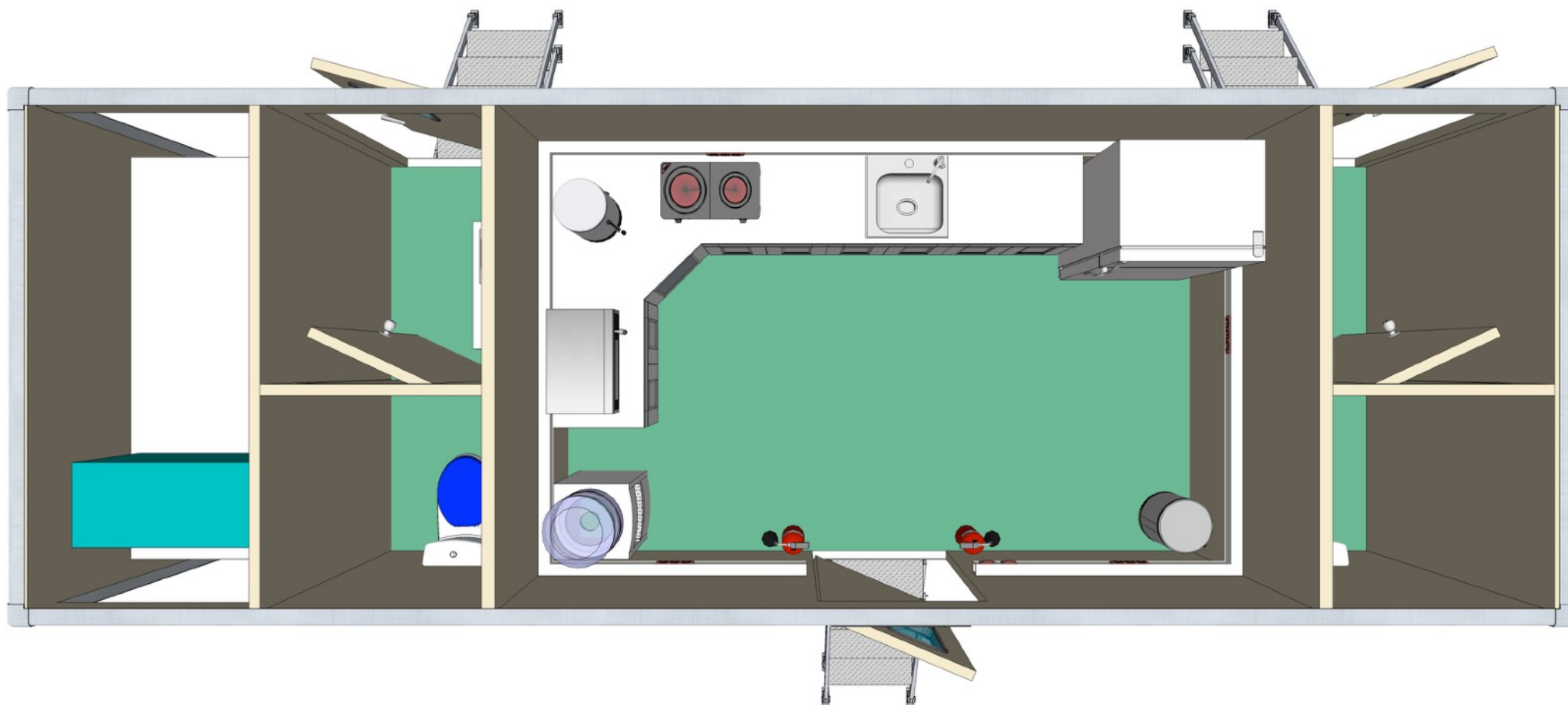

Cafeteria
Iveco Eurocargo 150E22H / WB: 5175

Prct. No : 18.245
 Rev. : 000
 Date : 27.10.2018
 Page : 8 / 12

ALURA TRAILER
 P: +90 332 3460080
 M :+90 544 242 04 91
www.aluratrailer.com

sales@aluratrailer.com



Equipment list

<p><i>Generator</i></p>		<p>12 kVa Stand By 11 kVa Prime 220 V Working Voltage Honda Engine GX 630 Automatic Start Air Cooling</p>	<p>1 pcs</p>	<p>HONDA</p>	<p>Japan</p>
<p><i>Generator</i></p>		<p>Plastik Fuel Tank 70 lt 80 X 28 X 40 Cm</p>	<p>1 pcs</p>	<p>CAN SB</p>	<p>Italian</p>
<p><i>Air Conditioning</i></p>		<p>3200 / 10900. Cooling capacity (watts/Btu/h) 1600 Heating capacity (watts) 230 volts AC/50 Hz Input voltage 5.9/6.5 – Current consumption R410a Refrigerant</p>	<p>1 pcs</p>	<p>DOMETIC</p>	<p>Germany</p>
<p><i>Kitchen</i></p>		<p>Kitchen countertops Mdf wood Polyester surface</p>	<p>1 pcs</p>	<p>ALURA</p>	<p>Turkey</p>
<p><i>Kitchen</i></p>		<p>Microwave 20 lt Volume 900 W Power 28.2 cm Height 37.7 cm Depth</p>	<p>1 pcs</p>	<p>ARCELİK</p>	<p>Turkey</p>
<p><i>Kitchen</i></p>		<p>Stainless steel body. Thermostat control. On, off indicator light. Overheating thermal protection system. Operating Voltage: 230V 50Hz. Power Consumption: 2500W</p>	<p>1 pcs</p>	<p>ARCELİK</p>	<p>Turkey</p>

Kitchen		Freeze Feature No Frost Energy Class A + Usage Type Solo Product Type Double Doors Height (cm) 171 Depth (cm) 77 Width (cm) 70 Sound Level (dB) 43 Volume (L) 454	1 pcs	BOSCH	Turkey
Kitchen		Electric Boiler Capacity: 15 lt Power: 2000 W Voltage: 220 - 230 V 50-60 Hz Dimensions: 325x320x470mm	1 pcs	MIRZA	Turkey
Kitchen		Water Dispanser 3 liter cold water boiler 1.1 liter hot water boiler 5 liters / hour water heating capacity 2 liter / hour water cooling capacity Hot water degree > 90c Cold water degree <10c> R134a refrigerant gas	1 pcs	VESTEL	Turkey
Kitchen		Waste Receptacle 20 lt.	1 pcs	KROM	Turkey
Bathroom		Filling Capacity: 8 Liter Sink Material: Stainless Steel	3 pcs	CANKROM	Turkey
Bathroom		Hot / cold, chrome. Height 15 cm. Hose length 150 cm.	3 pcs	CANKROM	Turkey

Bathroom		<p>Electric Water Heater 230 V ~, 50 Hz Power supply 3.7 A Power con. (at 230 V) 14 litres Water capacity 70 °C Temperature limit 2.8 bar Pump pressuremax. 4.5 bar System pressuremax. 3 kg Weight, emptyapprox. 405 x 405 x 295 mm Dimensions</p>	1 pcs	TRUMA	Germany
Bathroom		<p>Electric Toilet Introduction: 3/4 "female pass Output: 25mm internal hose with water lock and non-return valve Consumption: 400W for every siphon lasting about 6 seconds Water consumption: approximately 3.5 liters per siphon at 1.7 bar Outlet pump: Up to a maximum of 2.5 meters (hose length should not exceed 25 meters). Weight: 23 kg</p>	2 pcs	MATRO	Italy
Shutters		<p>Aluminum Shutters Manuel Working Locking Systems Size : 2100 x 1000 mm</p>	2	HAKSAN	Turkey
Outdoor Lighting		<p>5800 Lumens 240 Watts 30 Cm long 30,000 hours working life IP67 Standard</p>	4 pcs	ALURA	Turkey
Central Control Panel		<p>Control panel of all equipments</p>	1 pcs	ALURA	Turkey
Fire Extinguisher		<p>6 kg fire extinguisher refillable</p>	2 pcs	ALURA	Turkey



ALURA TRAILER

P +90 332 3460080 F + 90 332 3460090 M +90 544 2420491
Yazır Mah. Sultan Cad. 34/407 Selçuklu / Konya / TURKEY
www.aluratrailer.com sales@aluratrailer.com

